

<div><div>33059T-4ND</div><div>33063T-4ND</div><div>33064T-4ND</div></div> <div><div>Single Handle Basin Mixer - Paddle</div><div>Tall Single Handle Basin Mixer - Paddle</div><div>Super Tall Single Handle Basin Mixer - Paddle</div></div>
<div>BEFORE YOU BEGIN</div> <div><p>All information is based on the latest product information available at the time of publication. Kohler Co. reserves the right to make changes in product characteristics, packaging, or availability at any time without notice.</p><p>Please leave these instructions for the consumer. They contain important information.</p><p><b>NOTES:</b></p><div><div>1. Flush the water supply pipes thoroughly to remove debris.</div><div>2. An inline water filter must be used with this product.</div><div>3. If possible, install this basin mixer before installing the basin.</div><div>4. Inspect the supply tubing for damage and leakage. Replace and maintain as necessary.</div><div>5. Observe local plumbing codes.</div><div>6. Shut off the water supplies to the fitting.</div><div>7. All installations should comply with the relevant requirements of AS/NZS 3500 and AS/NZS 6400.</div></div></div>
<div>HANDLE OPERATION</div> <div><p>Lift the handle gently. Turn clockwise for hot water, turn counter-clockwise for cold water.</p></div>
<div>ROUGH-IN DIMENSIONS</div> <div><div><div><div>33059T-4ND</div></div><div><div><div>33063T-4ND 33064T-4ND</div></div></div></div></div>

INSTALLATION

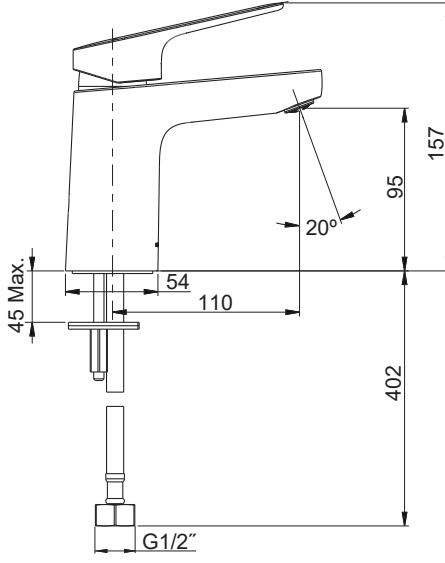
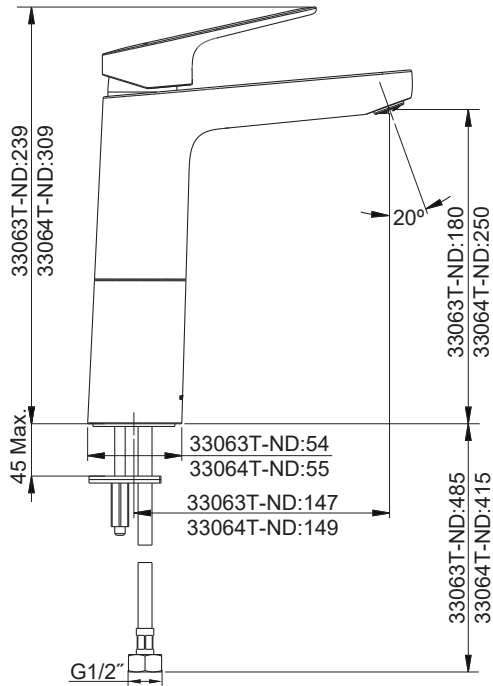
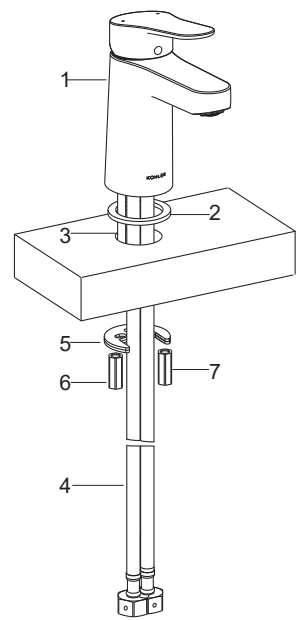

How to Install the Spout

Install the mounting studs(3) onto the underside of basin body(1), and put the adhesive washer(2) into the bottom groove of the basin mixer over the hoses(4) and mounting studs.

Insert the basin mixer assembly into the basin hole. Position the basin mixer properly. From underside, place the washers (5, Rubber washer is on the top) onto the mounting studs, and tighten nuts(6, 7) to secure the basin mixer.

Attach the hoses to water supplies. The hose with red mark should be connected to hot water, the hose with blue mark should be connected to cold water.

INSTALLATION CHECKOUT

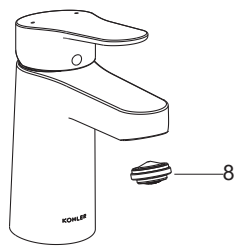

Ensure that all connections are tight. Ensure the handle is in the off position. Turn on the main water supply, and check for leaks. Repair as needed.

Remove the aerator kit(8) with a coin. Turn on the basin mixer. Run hot and cold water through spout for about one minute to remove any debris. Remove any debris from the aerator kit. Shut off the basin mixer. Reinstall the aerator kit.

CLEANING INSTRUCTIONS

All Finishes: Clean the finish with mild soap and warm water. Wipe entire surface completely dry with clean soft cloth. Many cleaners may contain chemicals, such as ammonia, chlorine, toilet cleaner etc. which could adversely affect the finish and are not recommended for cleaning.

Do not use abrasive cleaners or solvents on Kohler faucets and fittings.

- 33059T-4ND Single Handle Basin Mixer - Paddle
- 33063T-4ND Tall Single Handle Basin Mixer - Paddle
- 33064T-4ND Super Tall Single Handle Basin Mixer - Paddle

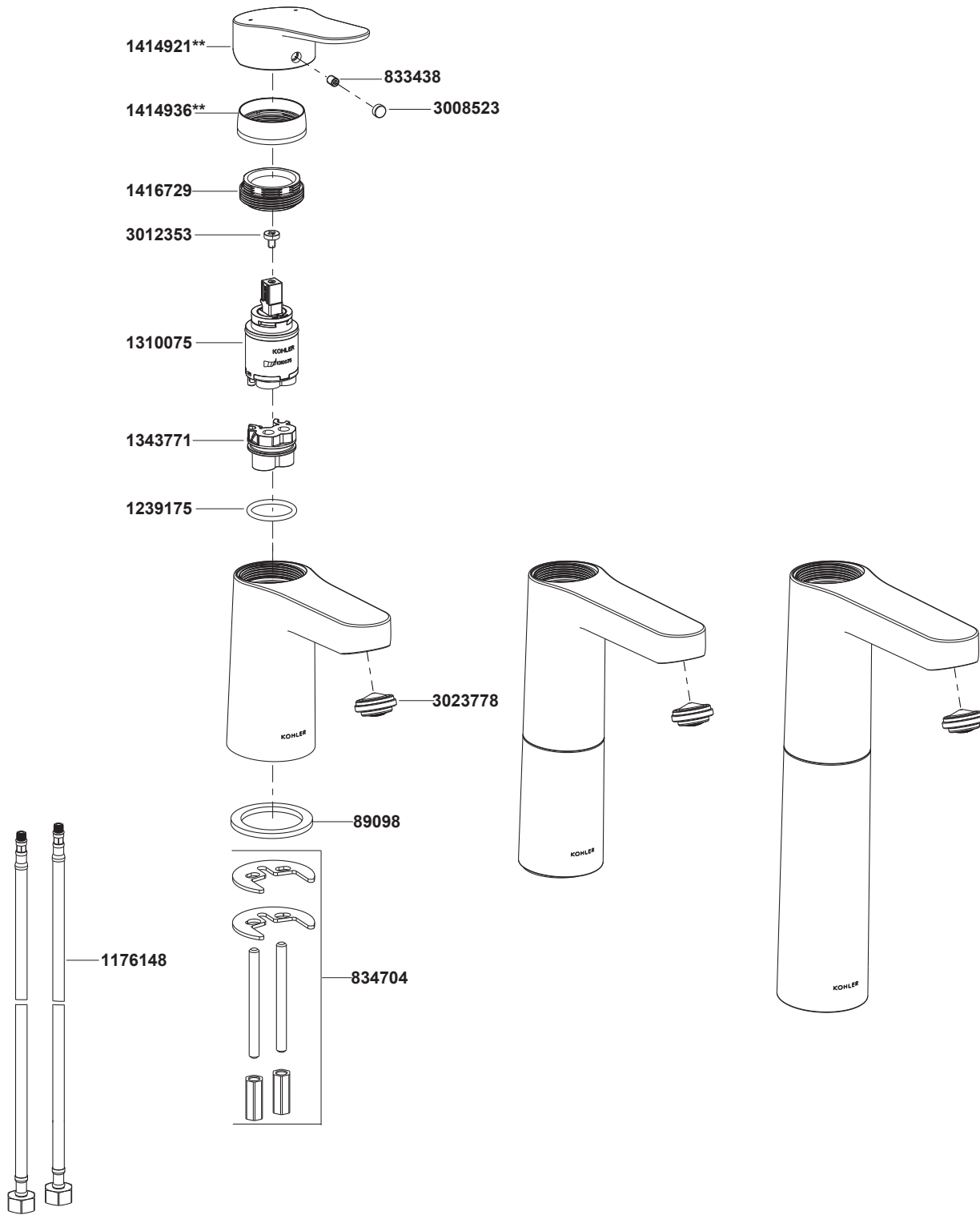

\*\*Color code must be specified when ordering.